

2012  
**FIVICS**  
PRODUCT GUIDE  
[www.fivics.com](http://www.fivics.com)





## The FIVICS quest for perfection is on-going

FIVICS pursuit of excellence is fueled by creativity, trial and error, and innovation coupled with a passion to bring you the shooter the best products available.

FIVICS President  
**Baek, Jong Dae**

A stylized white signature of Baek, Jong Dae.



***AT FIVICS,*** It is our mission to develop cutting edge innovations to help our customers reach their maximum potential. Technology, creativity and experience all come together to bring you, the customer, the best quality archery equipment available.



**ADVANCED  
SPACE-AGE  
TECHNOLOGY**

Top shooter's Choice  
**FIVICS!**





- STABILITY
- ACCURACY
- CLEAN SHOOTING FEELING
- STYLISH DESIGN
- TRIPPLE DAMPING SYSTEM

## FIVICS FX1 RISER

100% CNC

High performance recurve FX1 BOW  
Tuning and harmony are dramatically advanced

CLEAN FEELING SHOT  
SUPERIOR ACCURACY

Speed, Power, Balance, Precision, Elegance  
all working with you, the archer, in perfect harmony.  
The FIVICS FX1 Bow.

- The FX1 incorporates the "TRIPPLE VIBRATION ZERO SYSTEM" reducing vibration in three degrees.
- The FX1 "Center Control System" incorporates a steel ball, to reduce the movement up and down
- Stable grip - "V-ZERO damping system" is inserted inside of the grip to eliminate vibration and noise for a clean vibration free shot. Grip design ergonomics provide for an easy and exact "Target point" with maximum concentration, when at full draw.
- The FX1 system gives you stunning balance between Riser and Limbs working in perfect synchronicity for a truly exquisite shot.
- FX1's modern innovation & efficiency of design reduces pitching and yawing, this eliminates excess movement for the best shot experience.



We achieved a reduction in the yawing time



NORMAL RISER

FX1

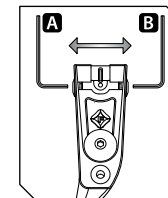

Loosen A and tighten B, then Center moves to direction B. After Set-up, please always tighten the bolt on the opposite side.

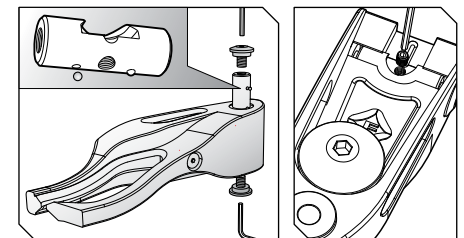

Steel ball included and fix with set bolt, to reduce the movement up and down in this system.



[HM-FX1]

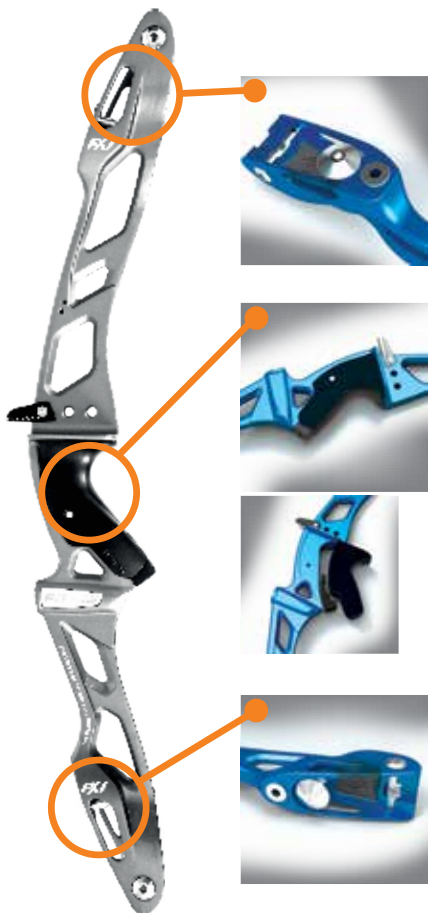

Top part of the riser : Absorption of vibration from limbs to the riser through inserted damping system at the primary contact point

Grip part : - Inserted damping system mid-riser offers the best shot feeling by eliminating vibration at this critical contact point with the archer's hand  
- FIVICS NEW ergonomic grip is created to offer the most exact and correct position for smooth shot execution

Low part of the riser : Absorption form the first vibration from limbs to the riser through inserted damping system

## High- polish ANODIZE



## F1 SPECIFICATIONS

LENGTHS	25"
MATERIAL	Aluminum(6061), Rubber
WEIGHT	1,240g
TYPE	RH / LH
COLOR	BLACK, BLUE, RED, YELLOW, GREEN, PINK



# FIVICS PXQ RISER



- FOCUS ON STABILITY AND ACCURACY
- REDUCED YAWING TIME
- EXCELLENT WEIGHT BALANCE



## FIVICS FX1 RISER

100% CNC

High performance recurve PXQ BOW  
Tuning and harmony are dramatically advanced

CLEAN FEELING SHOT  
SUPERIOR ACCURACY

Speed, Power, Balance, Precision, Elegance  
all working with you, the archer, in perfect harmony.  
The FIVICS PXQ Bow.

- The PXQ incorporates the "TRIPPLE VIBRATION ZERO SYSTEM" reducing vibration in three degrees.
- The PXQ "Center Control System" incorporates a steel ball, to reduce the movement up and down
- Stable grip - "V-ZERO damping system" is inserted inside of the grip to eliminate vibration and noise for a clean vibration free shot. Grip design ergonomics provide for an easy and exact "Target point" with maximum concentration, when at full draw.
- The PXQ system gives you stunning balance between Riser and Limbs working in perfect synchronicity for a truly exquisite shot.
- PXQ's modern innovation & efficiency of design reduces pitching and yawing, this eliminates excess movement for the best shot experience.

We achieved a reduction in the yawing time



NORMAL RISER PXQ

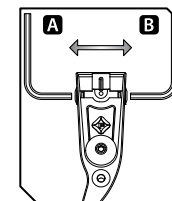

Loosen A and tighten B, then Center moves to direction B. After Set-up, please always tighten the bolt on the opposite side.

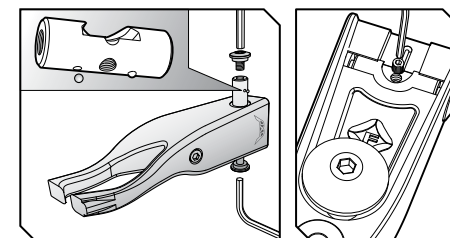

Steel ball included and fix with set bolt, to reduce the movement up and down in this system.



[HM-PXQ]

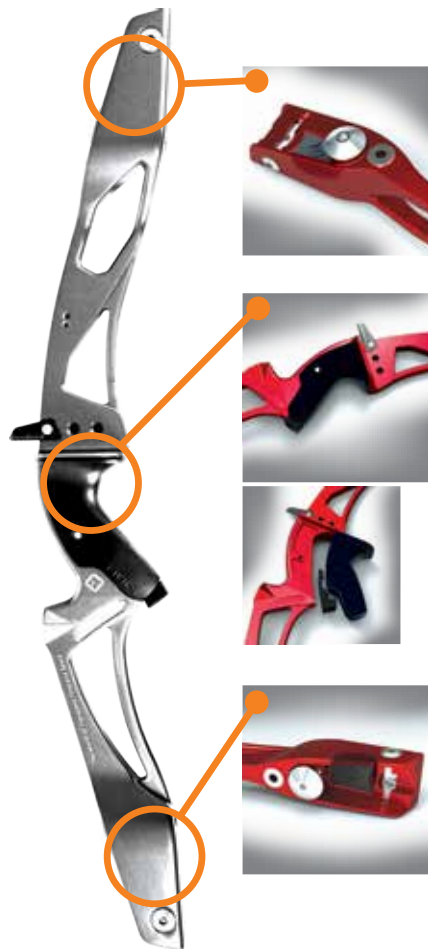

Top part of the riser : Absorption of vibration from limbs to the riser through inserted damping system at the primary contact point

Grip part : - Inserted damping system mid-riser offers the best shot feeling by eliminating vibration at this critical contact point with the archer's hand  
- FIVICS NEW ergonomic grip is created to offer the most exact and correct position for smooth shot execution

Low part of the riser : Absorption form the first vibration from limbs to the riser through inserted damping system

## High- polish ANODIZE



## PXQ SPECIFICATIONS

<b>LENGTHS</b>	25"
<b>MATERIAL</b>	Aluminum(6061), Rubber
<b>WEIGHT</b>	1,320g
<b>TYPE</b>	RH / LH
<b>COLOR</b>	BLACK, BLUE, RED, YELLOW, GREEN, PINK



[LM-FX1]



## THE WORTH OF TRANSCENDING TIME AND SPACE MERIDIAN FX1

### MERIDIAN-FX1 LIMBS

#### WHAT IS THE BEST?

In archery we try to reach the top of our game, the summit, the peak. To do this we search for the perfect balance between our potential and our equipment. Now FIVICS has the key to the top of your climb. The Meridian FX1

POWERFUL ENERGY  
POWERFUL SPEED  
CLEAN FEELING SHOT

Meridian -->> peak, high point, pinnacle. We call the FX1 "Meridian for a reason. It is the top. It is where you are trying to go. When you have the best limb you can have the confidence to reach your potential.

POWERFUL ENERGY  
POWERFUL SPEED

By combining space age materials with an innovative recurve profile, the Meridian FX1 limbs offer maximum energy transfer to the arrow. Speed, stability and precise delivery all work in harmony to give a shooting experience unlike any before.

#### SPECIFICATION

Using a premium wood core with high quality carbon to reduce the vibration, makes your shot fast and stable.

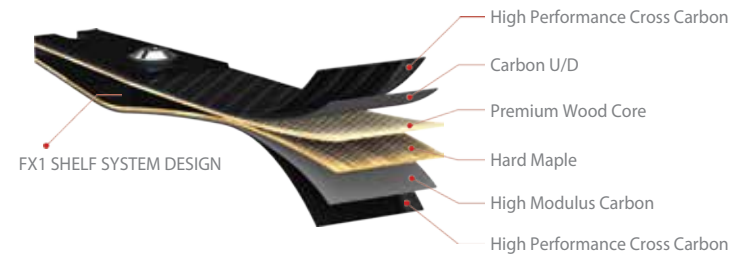

#### MERIDIAN FX1 & MERIDIAN RX1

Available Lengths : 66" 68" & 70"

Available weights : 28#~48# (Increments)

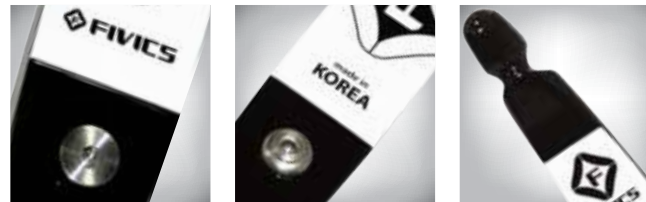



[PG-FX1]



## THE WORTH OF TRANSCEND TIME AND SPACE MERIDIAN RX1

### MERIDIAN RX1 LIMBS

The quest? Simple, to design a limb that exceeds all others.  
The method? Find out what archers want and go beyond.  
The vision? Create a limb that eclipses all expectations.

#### Premium Shooting Feel

FIVICS engineers have combined the latest in space age materials with cutting edge design innovations to bring you a limb with no equal. Introducing The MERIDIAN FX1 & MERIDIAN RX1

First we asked top archers what they liked and what they were missing in a limb. Then our scientists started from scratch to create a limb that was truly unique. A limb that embodied speed, accuracy and a pleasant shot, but took performance to a new level. Our proprietary design incorporates a whole new recurve geometry coupled with advanced carbon technologies to produce a limb destined to change the way we look at the recurve limb.

**FAST, SMOOTH, ACCURATE.....MERIDIAN FX1 & MERIDIAN RX1**

#### FORCE-DRAW CURVE

FIVICS "MERIDIAN FX1 / MERIDIAN RX1 Limbs medium length on 25" riser 40.3 lbs @ 28"/ 30" / 32"

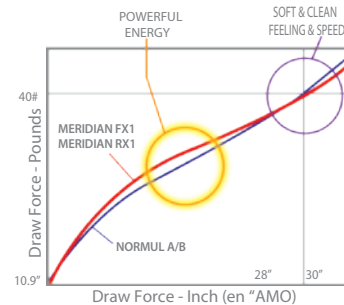

Draw Weight : 40.3 lbs @ 28"/30"/32"  
Limb Length : medium (68" Bow Length on 25" Riser)  
Brace Height : 7-3/4"-8-3/4" (depending on riser)  
Physical Weight : 365 Gramm oz (pair)

#### SPECIFICATION

Using a foam core with high quality carbon to reduce the vibration, makes your shot fast and stable.

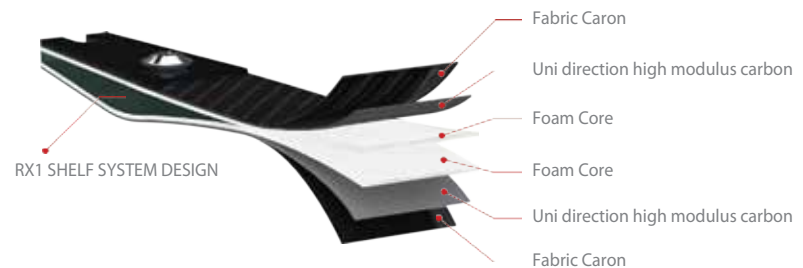



## FV-100 CARBON SIGHT



Exclusive style, Excellent Accuracy  
Simple system design  
Quiet with reduced vibration



[FV-100]

### Size

- Extention 9 inches (carbon)
- Extention 8 inches (aluminum)

### Anodized COLOR

- Black
- Silver



SPRING SYSTEM



3 HOLDING SYSTEM



## FV-200 CARBON SIGHT



Best accuracy  
Stronger solid and detailed design



[FV-200]

### Size

- Extention 9 inches (carbon)
- Extention 8 inches (aluminum)

### Anodized COLOR

- Black
- Silver
- Blue
- Red



3 HOLDING SYSTEM

## SIGHT CASE

### A Style

Well-arranged pocket system,  
durable case, fancy design



[EA-CS]



### COLOR

- Black
- Red

### B Style

Cute designed sight case



[S-CS]

### C Style

Handy sight protection case



[S-CSC]

### COLOR

- Black
- Blue
- Red



## SM740 CUSHION PLUNGER

Designed to reduce friction with BTX coating.  
 Designed neatly with internal innovations for advanced micro-adjustments.  
 Smooth contours for the best aerodynamics to reduce effects from the wind.

Thread : 5/16" - 24

Adjustable Length : min 19.5mm, max 26.5mm



[CP-24/29]

Anodized  
COLOR



## FIVICS PULL - FOR ALL ARCHERS

Ergonomic detail design for both your fingers and shaft for safety.  
 Fancy colors, soft feel, but highly effective.

Easy to use

Anodized  
COLOR



[AR-P1]



## TC REST

Height adjustable high-end rest  
 Durable construction for precise and secure positioning



[MR-T]



## MR REST

Solid design for zero tolerance of error in position and angle.  
 Stainless steel ensures durability while reducing friction.



[MR-A]

## PR REST

Durable, inexpensive beginner rest



[PR-F]



## PHOENIX COMPOUND STABILIZER

Weights and vibration problems? Solved!

New compound tournament stabilizer, 'PHOENIX' incorporates an advanced high elastic material. Normally, compound top pro-archers use many weights on the stabilizer, but a normal stabilizer cannot control the weights and vibration together. However, the NEW PHOENIX OURNAMENT stabilizer has a very strong spine, which means no noise and vibration. Now it's ok to use many weights, because more weight equals better vibration reduction like never before. Moreover Phoenix Tournament stabilizer has a light but durable spine, it's ideal for all men and women.

Painted  
COLOR



Carbon  
Graphic

<b>Long Stabilizer</b>	24", 27", 30", 34"
<b>Side Stabilizer</b>	8", 10", 12"
<b>Extender</b>	4", 5", 6"

### WEIGHT

Thread Size : 1/4-20 UNC  
Size : 38mm(5T/3T) , 24mm(5T/3T)

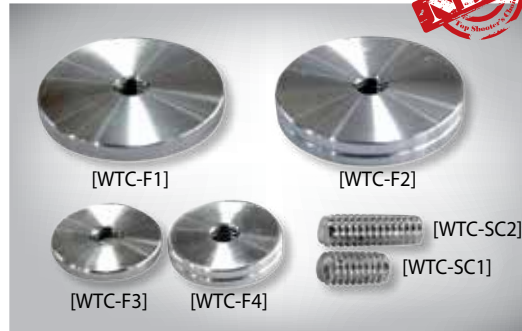

### THE INNOVATION OF SHOOTING FEELING



- High Elastic material
- Strong spine
- No noise , No vibration
- It's ok with lots of weights
- Great stability
- light shaft

Strong Spine





## CEX7 STABILIZER

High-end stabilizer from FIVICS offers shooter stability and balance. Stabilizer cap designed for aerodynamics.

CEX7 carbon balance system.  
Best Durability and weight balance.

Painted  
COLOR

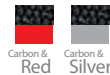

Long Stabilizer	26", 28", 29", 30", 34"
Side Stabilizer	10", 11", 12"
Extender	4", 5", 6"



## WEIGHT

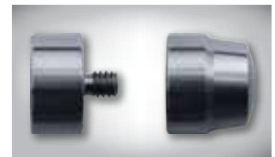

[WT5-F] [WT5-H]

**CEX7 stabilizer is threaded at both the shaft end, and cap. It can never come off.**



## VZ 2000 DAMPER



Fit any stabilizers.  
Eliminates noise at inside bolt.  
Best damper absorption system



[VZ-SCR]



[VZ-2000]

[VZ-2200]

## VZ 1500 DAMPER



Designed to fit any stabilizer  
Best V-ZERO damping system  
No noise with rubber bolt inside



[VZ-1500]

## V-ZERO DAMPER



[VZ-1000]

[VM5-1000]



## CEX5 STABILIZER

The aim of the CEX5 stabilizer is total balance and harmony with the arrow. It's the best stabilizer for speed and vibration reduction, CEX5 has passed careful inspection successfully, it makes archers confident, it is different from other stabilizer

To eliminate even the smallest vibration  
Support the highest speed and stability  
Oscillation control available for both recurve and compound bow

Special Strong Spine Material

Long Stabilizer	26", 28", 29", 30", 34"
Side Stabilizer	10", 11", 12"
Extender	4", 5", 6"

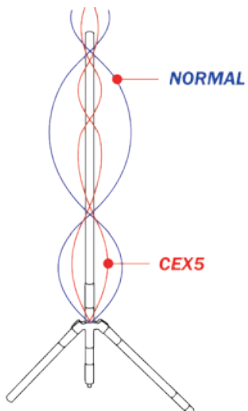

Check over the Vibration (Right and Left)

### THE INNOVATION OF SHOOTING FEELING

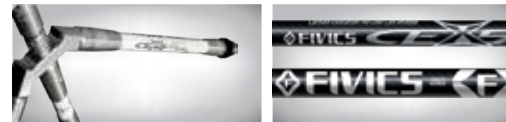

Whole Vibration of it's Body

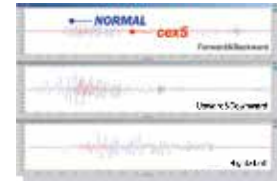

### WEIGHT

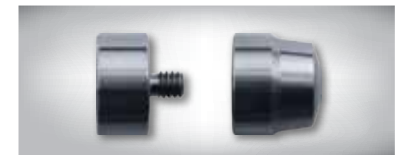

[WT5-F]

[WT5-H]



#### Painted COLOR



- 2 Tone Carbon & Red / Carbon & Blue / Carbon & Silver / Carbon & Black
- 1 Tone Red / Blue / White / Orange



# GIGS STABILIZER



GIGS stabilizer, new style of carbon rods made by a high and carbon layer. GIGS offers the shooter better balance and accuracy. Excellent performance and easy tuning.

<b>Long Stabilizer</b>	24", 26", 28", 30"
<b>Side Stabilizer</b>	10", 11", 12"
<b>Extender</b>	4", 5", 6"

## WEIGHT

Thread Size : 1/4-20 UNC  
Size : 38mm(5T/3T)

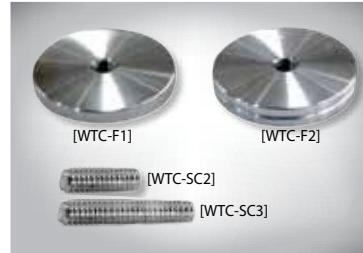

# CEX2+ STABILIZER



"New CEX-2+ weave of pure carbon layer gives Hawk's Baek unequalled strength, even on light weight pure carbon shafts. The cross-woven method of construction is proven to deliver exceptional strength without added weight.

<b>Long Stabilizer</b>	24", 26", 27", 28", 29", 30"
<b>Side Stabilizer</b>	9", 10", 11", 12"
<b>Extender</b>	3", 4", 5", 6"

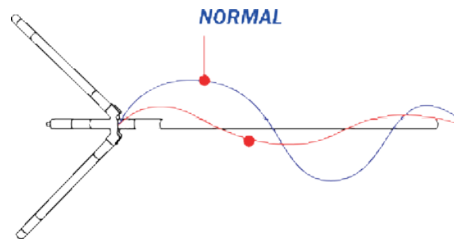

Check over the Vibration (Up and Down)

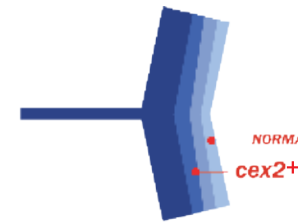

check over the Vibration (Bow Speed)

## WEIGHT



[WT-F] [WT-S] [WT-H]





## MAN V-BAR



[VB-B]

Angle : 40° / 45°



## COM V-BAR

Fully adjustable offset side mount Compact, solid machined aluminum Adjustable Angle Measurement System Available in black only



Color: Black  
Material: Aluminum

[CO-AC]

## RF V-BAR



[VB-R]



Small but light and durable.  
A perfect combination for balanced shooting

Angle : 40° / 45°

Weight : 75g (Connecting bolt included)

## TR V-BAR



Adjustable 360.  
Horizontal and vertical adjustable system.  
Easy to use



[VB-T]

Color: Dark Gray  
Material: Aluminum

## SP V-BAR



[VB-S]

Best shot feeling

Angle : 40° / 45°



## COM CONNECTING BOLT

A much better connecting bolt that gets Long stabilizers 10 degrees lower, and absorbs vibration Easy and quick detach system

❖ 10Degree Lower

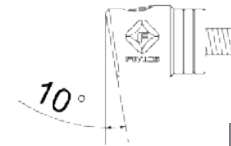

Color: Black  
Material: Aluminum



[CA-C]

## UNI-BAR

[UNI]



# TOP UPSTABILIZER TNS SET

Versatile vibration reduction system design and material  
Available variety color



TNS N300



TNS 1000



TNS 500

Anodized COLOR



## TNS 300

TNS 300 SET : TNS 300 + V-Zero damper + weight head

Anodized COLOR  
Black Silver



[TNS 300]

# SQ EXTENDER



V-zero damping system insert extender.  
Stainless rod is also inserted in the rubber.  
SQ extender is the best noise elimination system.

weight : 160g

Anodized COLOR



[SQ-E]

# N-SHOCK DAMPER

N-shock damper by BJD technology uses slogan,  
"NO SHOCK", "NO VIBRATION", "NO NOISE" Perfectly matched  
with all stabilizers from FIVICS.

Size : 39 x 20 x 20mm  
Material : Aluminum, Rubber  
Color : Black, Silver, Blue, Red



Weight : 24g



[NSD-A/B]



## SAKER 1 FINGER TAB

Anodized aluminum plate  
Adjustable ledge  
Replaceable faces and backing  
Optional finger spacer available



[SK-1]

Size : XL / L / M / S / XS / XXS (RH / LH)  
Leather : Cordovan

Anodized COLOR



## SAKER 2 FINGER TAB

Anodized aluminum plate  
Adjustable ledge  
Replaceable faces and backing  
Optional finger spacer available

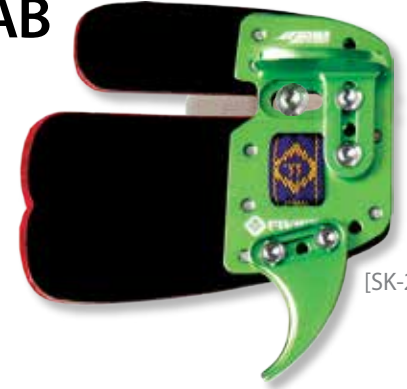

[SK-2]

Size : XL / L / M / S / XS / XXS (RH / LH)  
Leather : Cordovan

Anodized COLOR



## SAKER 3 FINGER TAB

Anodized aluminum plate  
Adjustable ledge  
Replaceable faces and backing  
Optional finger spacer available



[SK-3]

Size : L / M / S (RH / LH)  
Leather : Cordovan

Anodized COLOR



### Ergonomic Finger Tab

Finger support patent®

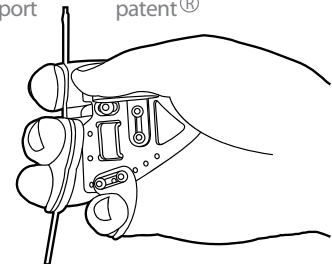
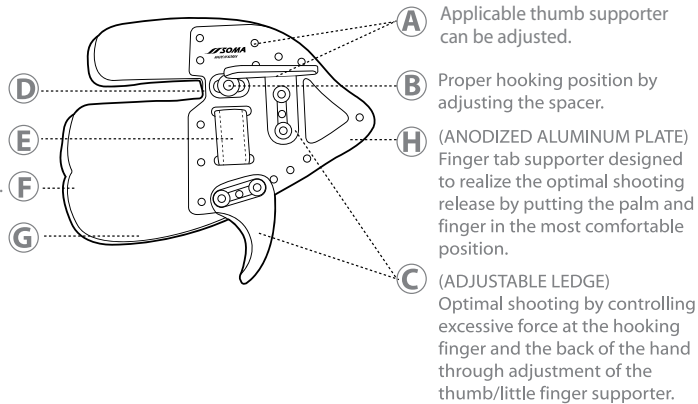

Plate notched to give nock clearance at full draw.

'NEW' cord and lock

To fit shape of your 3 fingers.

The cordovan provides a smooth, consistent surface that ensures the highest quality and water resistance.



# TAB FRAME EP



## FB-EP only fit Saker1 finger tab

It offers top shooters another value for their hooking direction, comfortable and balanced. This component enhances the saker finger tab's ergonomic design

Size : saker1 XL , L = EP (L size)  
 saker1 M , S = EP (M size)  
 saker1 XS , XXS = EP (S size)



[FB-EP]

# CORDOVAN TAB



Functional with hand protected cordovan leather  
 Light and soft



[PR-200]

ALL CORDOVAN

# FINGER SPACER

Material : Plastic



[FS-A]

Material : Rubber

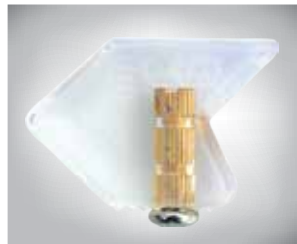

[FS-B]

Material : Aluminum  
 Comfortable Spacer



[FS-C]





# COMPOUND BOW CASE THUNDER CC



[CPC-T]

Interchangeable wheel



Arrow tube + equipment case included

- Protect compound bows with durable fabric and angled case
- Extra pockets for accessories
- Convenient to carry
- Easy transportation system with durable wheels
- Room for two compound bows

dimension : 15" x 45" x 12"

Fabric COLOR



Red



# RECURVE BOW CASE THUNDER RC



[RCC-700]



Interchangeable wheel

Convenient to carry  
Easy transportation system with durable wheels  
Room for two compound bows

dimension : 14" x 36.5" x 12"

Fabric COLOR



Red



Arrow tube + equipment case included





# CO-STAR BACKPACK



Stylish hybrid backpack



[BP-C4]



- Arrow tube
- Equipment case
- Riser & Limbs case included



Fabric COLOR



Black Blue Red



# TENTRON-Q BACKPACK



Light, well-organized pockets, simple and casual system

Fabric COLOR



Black Yellow



[BP-C3]



# AEGIS HARDCASE

High quality hardcase  
 This model can hold up to two recurve bows and their accessories  
 It is equipped with a locking system with key

Size : 85cmX38cmX26cm  
 Material : ABS  
 Pocket : 1 pcs



[HC-A]

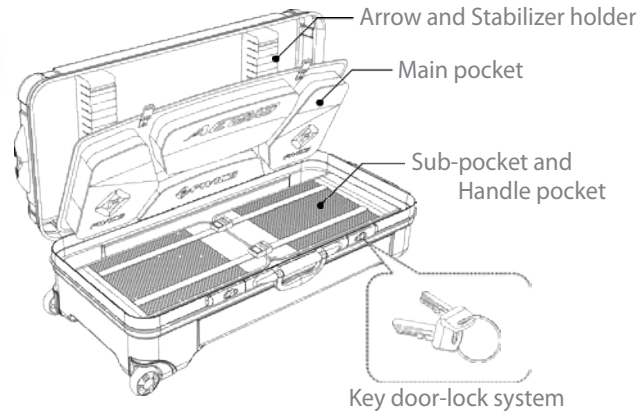

Rain cover / Case belt included

## RAIN COVER



[HC-RC]



## CASE BELT



[HC-BT]



# COMPOUND BOW CASE V-STORM CC

Simple and convenient design with the best quality.  
The best elastic cushions increase  
The safety and security of the bow  
Simple arrangement with 2 outer  
Pockets and one inner pocket

Size : 97cm  
Pocket : 2pcs



[CPC]

# RECURVE BOW CASE V-STORM RC 500

Size : 92 cm  
Pocket : 2pcs

[RCC-500]



# V-STORM RC 300

Size : 89cm  
Pocket : 2pcs

[RCC-300]



# RISER CASE

[RS-CS1]



# LIMBS CASE

[LM-CS]



# RISER & LIMBS CASE

[LR-CS]



# TENTRON-M BACKPACK



Size : 30cm X 20cm X 68 cm  
Pocket : 1pcs

Fabric COLOR



Black Blue Red

[BP-C1]



Special ergonomic design  
Organizational pockets for today's latest technology  
Reflex cloth used for safety, durable material and brightly colored



- Arrow tube
- Rain cover
- Riser & Limbs case included

# TENTRON-P BACKPACK



[BP-C2]

Arrow tube / Riser & Limbs case included



Size : 30cm X 18cm X 68cm  
Pocket : 2pcs

# EQUIPMENT CASE



Well-arranged and slim design fits all equipment inside  
(sight, short stabilizer, extender, v-bar, wrench set etc)

Size : 30cm X 20cm X 68 cm



[EC-09]



Fabric COLOR



Black Blue Red



QUIVER

# ACCENDO TOURNAMENT QUIVER

For T-gauge  
Large room for accessories  
Pen holder  
Record carrier

Size : 38cm(width) X 49cm(heigh) X 7.5cm(thickness)  
Belt size : 31"~ 43" / 36" ~ 48" (inch)  
Weight : 630g

Fabric COLOR : RH / LH



# 630g

It's light like a feather.  
Do not lose it!

## New quiver line

Luxurious design  
Light and durable



[AC-Q]

(design Patent Pending)



For T-Gauge

For pens, records



Non-slip material

Back side of the belt

# ACCENDO BACK QUIVER

Luxurious, but simple & light design

Size : 22cm(width) X 46cm(heigh) X 7.5cm(thickness)

Belt size : 31"~ 43" / 36"~ 48" (inch)

Weight : 260g



[AC-QM]

Fabric COLOR : RH / LH



# NURI

Luxurious quiver  
Pockets for wrench set  
Room for all of your accessories

Belt size : 32" ~44" (inch)

COLOR : RH / LH



[AM-1]

# MIRACLE 500

Double pocket system  
High performance line

Belt size : 32" ~44" (inch)

Fabric COLOR : RH / LH



[MC-05]

# METEOR 500

Simple and light  
3 tube design

RH / LH



[MT-Q5]

# FREENIC PLUS

Upgraded stylish design  
Simple and durable

Belt size : 32" ~44" (inch)

Fabric COLOR : RH / LH

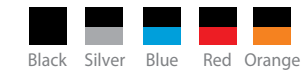

[LS-Q3]

# MIRACLE 300

Multiple fasionable colors

Belt size : 32" ~44" (inch)

Fabric COLOR : RH / LH

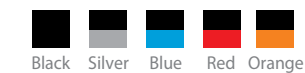

[MC-03]

# METEOR 300

Bright color  
2 tube design

RH / LH



[MT-Q3]



## 3LEVELS FOLDING BOW CASE



Innovative design : Very easy to carry your complete set of equipment.

Fabric COLOR



## STABY CASE



Case for full stabilizer set

[SC-10]



Fabric COLOR



## SHELTER PLUS CHEST GUARD

Highly comfortable and safe ergonomic design.

Weight : 94g

Fabric COLOR



## A2 CHEST GUARD

Elastic Shoulder Band  
Adjustable Side Fastener

Fabric COLOR

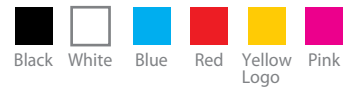

[AP-A2]



## RAINBOW SHIELD ARMGUARD



## HK EQUIPMENT HOLDER



[HK-A]



## TK2 HAND POCKET



[TK-A]



[TK-B]

## GABO BOW STAND



Spring - loaded  
Aluminum body makes setting simple.  
Conveniently designed stand

Height : 44cm  
Weight : 573g  
Material : Aluminum



## AQUILA BOW STAND

Height : 48cm  
Weight : 360g  
Material : Rubber / Aluminum

3 Stable legs

Flexible Rubber



## AUTOMATIC BOW STAND

Height : 44cm [ST-A], 65cm [ST-B]  
Weight : 573g [ST-A], 680g [ST-B]  
Material : Aluminum





## Premium Shooting Feeling **PEGASUS**

### Multi-core System!!

1. Complete Strong power, speed and stability.
2. Premium wood core and high quality of carbon's extreme elasticity help limbs to be recovered from the vibration.
3. Push the tip part from limbs with Powerful shooting feeling.

Available lengths : 66" 68" 70"  
 Available weights : 26#~48#  
 ( In 2# increments)

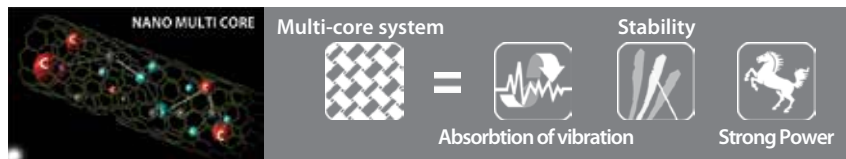

### What Multi-core system is!

Using premium wood core with high quality carbon to reduce the vibration, makes your shot fast and stable.

### SPECIFICATION

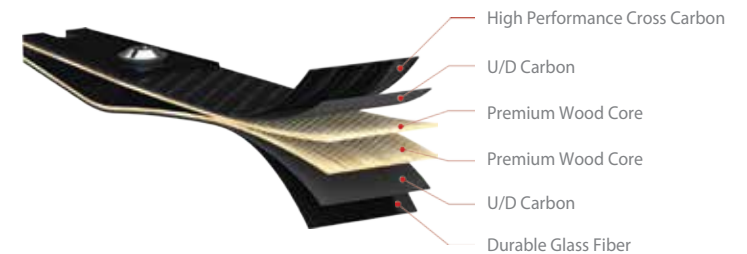

Top shooter's Choice **FIVICS!**

▮ ADVANCED SPACE-AGE TECHNOLOGY ▮





## SCORPION SIGHT



High quality recurve target sight strong, light-weight aluminum construction

Size : 9.5" (inch) (RH / LH)

Anodized COLOR



[SC-E]

## FALCON SIGHT

Mid-level target sight Light aluminum construction  
Quick detach bow mount  
Available in black only

Size : 4" (inch) (RH / LH)

Anodized COLOR



Black



[FA-A]

## BLACK SHARK



High-impact polymer and nylon  
Light weight and durable  
Great introductory sight

Size : 4" (inch) (RH / LH)

Anodized COLOR



Black

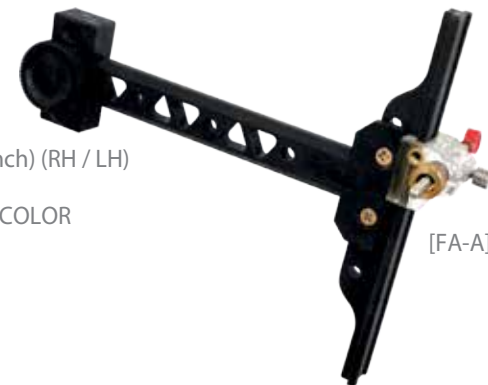

[FA-A]

## JM FINGER TAB



Size : L / M / S (RH/LH)



Leather : Cordovan - [JMT-1CO] , [JMT-2CO]  
Cowhide - [JMT-1HD] , [JMT-2HD]

## NEONINE FINGER TAB

Size : L / M / S (RH/LH)  
Leather : Cowhide



[NA-A]

[NA-B]

## MAGIC FINGER TAB

Size : L / M / S (RH/LH)  
Leather : Cowhide



[MG-A]

## SPORTER FINGER TAB

Size : L / M / S (RH/LH)  
Leather : Cowhide

Size : 17mm ~ 25mm



[ST-A]

## CLOVER FINGER TAB

Size : L / M / S (RH/LH)  
Leather : Cowhide



[CV-200]

# HQ ARMGUARD



[HQ-P]

COLOR



# SPIDERMAN ARMGUARD



[SP-P]

COLOR



# SUPERKING ARMGUARD

Size : S/M/L



[SP-L]



[SP-M]

[SP-S]

# COMPOUND BOW STAND

Works on most bows easily slips into quiver or pocket light weight folding kickstand not spring loaded available in black only

Weight : 94g  
Material : Plastic



[CST]

# LVT V-BAR

Anodized COLOR



[LVT-B]

[LVT-V]  
Angle: 35° / 40°

# LVT STABILIZER

Includes v-bar long, short, stabilizer damper and end weight

Vibration reduction shock eater design  
High quality carbon construction  
Available color: silver / black

Long Stabilizer	26", 28", 30"
Side Stabilizer	10", 12"
Extender	3", 4"

Anodized COLOR



[LVT-E]

[LVT-S]

[LVT-L]



## ARM SUPPORTER

Arm Supporter helps to deliver Strength to back of the arm and to prevent using fingers when beginners Shoot.

Size : S / M / L



[AS-B]



## HEX-I ALLEN WRENCH

Ergonomic simple design  
Compact and portable  
Colorful, durable and exquisite wrench

Material : Aluminum

Weight : 90g  
Spec : 1.5 / 2.0 / 2.5 / 3.0 / 4.0 / 5.0

┌ Metric ┐    ┌ Inched ┐  
Purple Rad    Blue Yellow



[HAW-1]



[HAW-2]

## GRAIN SCALE

LCD digital screen display  
15 grain accuracy  
Weights - Grains, Grams,  
Ounces and CWT  
Extremely small 5"X3"X3/4"  
Lightweight 6 oz

Model : 60200  
Description : Electric Scale  
Inner Pack : 3  
Case Pack : 12



[GSE]

## SLING



It's soft but stronger material is highly durable.



[SG-10]



## LIMB PROTECTOR

Limb set up supporter Protects top of the foot  
Comfort & Easy to use Double Comfort and  
easy to use double sided



Size : 56 X 97 mm  
Material : Enamel , Rubber



[LP-1]

# BLAZE BEGINNER BOW

Handle	19", 20", 24"
Limb	54", 62", 64", 66", 68", 70"
Pound	10~24 / 14~36 / 16~38 / 12~34 / 14~36 / 18~38
Material	Hard maple, Rosewood, Walnut, fiber glass



[WB-HL]

# LEO CUSHION PLUNGER

Precision manufacturing for zero tolerance error.  
High endurance BTX coating for the elimination of friction.



[LEO-C]

Anodized COLOR



Black Silver

# QUICK GRIP MARKER

Customize your grip!  
Our material gives you a simple and fast solution that can be molded and cut easily for a sure fit to your unique hand. Hardens and is waterproof in 80 minutes.



Size : 4 inch, 8 inch

[GM-8]



[GM-4]

How to use :



CUT

MIX

APPLY

SANDING

# SE-C CHEST GUARD

Simple and Light



[SE-C]

# STRINGER



Strong string with tough cowhide



[SG-11]



## STRETCH BAND

This stretch device is used by most Olympic archers for training.  
Use to warm-up, stretch and develop muscles.  
Great for practicing form



[LB-L]  
Yellow

[LB-H]  
Green

Size : 20m X 15cm X 0.2mm

## KIDS BOW SET

- ⊙ BOW - 1EA
- ⊙ SAFETY ARROW - 6EA
- ⊙ TARGET BOARD 430mm - 1EA
- ⊙ QUIVER - 1EA
- ⊙ MAGNETIC DART - 8EA



[YB-A]



Size : 414mmX694mm [YB-A]

## STRAFE BOWSTRING

67% SK75 dyneema, 33% vectran  
Half the strand size of 450 plus  
Slightly higher arrow speed  
More strand count improves flexibility.  
Looks great for multi-colored strings

No creep : completely stable  
Recommended strands : 22 / 24  
Approx ft / lb waxed : 8800  
Speed size : 1lb



## PHONE RING

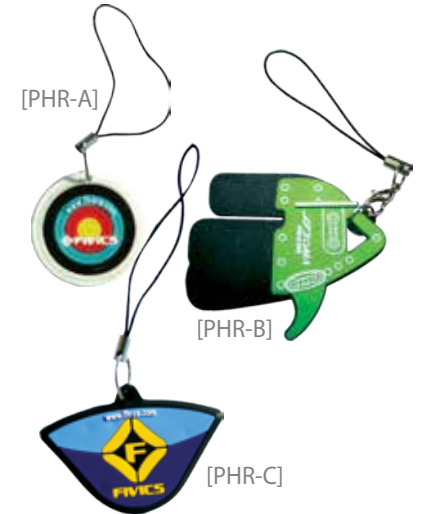

## DACRON BOWSTRING

Strings : Meticulously ready made string  
RECURVEBOW & TRADITIONAL BOW & CROSSBOW

Material : DACRON STRING & NYLON SERVING  
Serving color : Red/Blue/Green/Yellow/White/Black



## CLOCK



[CLK]

# CLOTHES

Size : S / M / L / XL / XXL



[FT-A]



[FT-B]



[FT-C]

COLOR : Black / White

## CAP



[FC-A]



[FC-B]



[FC-C]



[FC-D]

## SOCKS



[SO-A]



[SO-B]



ASIAN FIRST  
TARGET FACE LICENSED  
MANUFACTURER BY FITA

Water Proof Target Face

## FIVICS Target Face Function

[Out Door, In Door, Training, Field]

- + Material : Polyester
- + Thickness : 0.29mm
- + Tensile strenght (kg/cm2) : (L- 40.0 / W- 17.0)
- + Temperature range : -32 ~ 260 C
- + Printing error range : 99.9% (Best "Quality")
- + Average shootings : Over 500~800



[Available also in economic Target face in all the range of size]

- + Waterproofing
- + Useable under any weather condition
- + High tensile strenght and coherence
- + Little crumpling and tearing
- + Hardly change in the shape and color
- + Allow no light reflection
- + No damage to the score line
- + Favoring environment - availble recycling and safe incineration
- + Safely transportable and manageable, and unnecessary protective equipment

# ADVANCED SPACE-AGE TECHNOLOGY



## NANO-PRO

**Nano-Pro™** Nano-Pro is our newest nano-carbon arrow designed specifically for FITA, NAA, long-distance field shooting. Engineered with incredibly light yet strong 46-ton carbon, Nano-Pro recovers even faster out of the bow than Nano-XR while delivering the flattest trajectory and superior down range accuracy. It has the smallest diameter of any of our target arrows, which means, it nearly eliminates cross-wind drift. And unlike aluminium core arrows, Nano-Pro won't take a set (permanent) bend.

Spline-Selected for a consistent matched set.

### FIVICS Pin Nock

This universal pin nock fits all standard pin nock adapters. It is made from a durable polycarbonate material that performs shot after shot.

Size: S / L

Color:



## NANO-PRO Components



1P (450 ~ 600), 2P (650 ~ 900)  
Stainless Steel Target Point (PSL-P)



Tungsten Target Point (PTG-P)



400 ~ 900  
Nock Collar (NP-NC)



600 ~ 700  
750 ~ 900  
400 ~ 550  
Pin Nock Adapter (PTL-P)



FIVICS Pin Nock (Pi-n)

Shaft Size / Qty	ShWeight (Grain)	Spine	Diameter
900 / 12pk	5.3	900	0.177"
800 / 12pk	5.7	800	0.180"
750 / 12pk	6.0	750	0.183"
700 / 12pk	6.2	700	0.184"
650 / 12pk	6.4	650	0.186"
600 / 12pk	6.8	600	0.190"
550 / 12pk	7.1	550	0.193"
500 / 12pk	7.5	500	0.196"
450 / 12pk	8.0	450	0.200"
400 / 12pk	8.6	400	0.205"



# NANO-XR

**Nano-XR™** Introduced in 2007, Nano-XR was the first target arrow engineered from 40-ton carbon to deliver superior down-range accuracy, strength and consistency shot after shot. It's ultra small diameter dramatically reduces cross-wind drift and is the ideal arrow for FITA, NAA and NFAA long-distance shooting. In side-by-side tests, Nano-XR consistently outperformed comparable aluminium core/ carbon arrows in strength, recovery out of the bow, consistency and velocity (for more, visit nanokr.com). In only its first year on the market, Nano-XR won the Gold Medal at the 2007 FITA World Championship.

Spline-Selected for a consistent matched set.

## FIVICS Pin Nock

This universal pin nock fits all standard pin nock adapters. It is made from a durable polycarbonate material that performs shot after shot.

Size: S / L

Color:



## NANO-XR Components

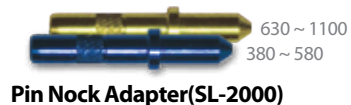

Shaft Size / Qty	ShWeight (Grain)	Spine	Diameter
1100 / 12pk	4.9	1100	0.181"
1000 / 12pk	5.2	1000	0.184"
900 / 12pk	5.5	900	0.186"
830 / 12pk	5.8	830	0.189"
730 / 12pk	6.2	730	0.191"
680 / 12pk	6.4	680	0.194"
630 / 12pk	6.6	630	0.196"
580 / 12pk	7.2	580	0.201"
530 / 12pk	7.5	530	0.203"
490 / 12pk	7.8	490	0.205"
450 / 12pk	8.1	450	0.208"
410 / 12pk	8.6	410	0.212"
380 / 12pk	9.0	380	0.214"



## ZEILO

**ZEILO** is the target arrow for youth and beginners. NEW Acrossweave of pure carbon layer gives the Baek's unequaled strength, even on lightweight pure carbon arrows. This cross-woven method of construction is proven to deliver exceptional strength without adding weight.

### FIVICS Pin Nock

This universal pin nock fits all standard pin nock adapters. It is made from a durable polycarbonate material that performs shot after shot.

Size: S / L

Color:



Available in two size: #1 fits 12-18 strand strings  
#2 fits 20-24 strand strings

### ZEILO Components



Stainless Steel Target Point (SN-1000)



Pin Nock Adapter (SI-1000)



FIVICS Pin Nock (PI-N)

Shaft Size	ShWeight (Grain)	Spine	Recommended Point Weight Range
500	9.22	500	110g / 120g
600	8.76	600	110g / 120g
700	8.18	700	110g / 120g
800	7.61	800	110g / 120g
900	7.26	900	110g / 120g
1000	6.97	1000	110g / 120g
1100	6.72	1100	110g / 120g
1200	5.59	1200	110g / 120g
1300	6.54	1300	110g / 120g
1400	6.26	1400	110g / 120g
1500	6.07	1500	110g / 120g

### X-NET Point and reverpin is designed for X-10 arrows



Stainless Steel Target Point (SN-X10)



Pin Nock Adapter (SI-X10)



FIVICS Pin Nock (PI-N)

SIZE: 120g, 110g, 100g, 90g

COLOR: Gold, Blue, Red

COLOR: Yellow, Red, Green, Blue



## FIVICS Target Arrow Shaft Selection Guide

### Adjusted Bow Draw Weight

Bow Draw Weight	23"	24"	25"	26"	27"	28"	29"	30"	31"	32"
19~24 lbs.	ZE 1500 NA 1100	ZE 1400 NA 1100	ZE 1300 NA 1100	ZE 1200 NE 1400 NA 1000	MXR 1000 NP 900 NA 900	MXR 900 NP 800 NA 830	MXR 800 NP 750 NA 730	MXR 700 NP 700 NA 680	MXR 600 NP 650 NA 630	
25~34 lbs.	ZE 1300 NA 1100	ZE 1200 NA 1000	MXR 1100 NA 1000	MXR 1000 NP 900 NA 900	MXR 900 NP 900 NA 900	MXR 800 NP 800 NA 830	MXR 700 NP 700 NA 680	MXR 600 NP 600 NA 580	MXR 600 NP 600 NA 580	
35~39 lbs.	MXR 1200 NA 1000	MXR 1100 NA 1000	MXR 1000 NP 900 NA 900	MXR 900 NP 800 NA 830	MXR 800 NP 750 NA 730	MXR 700 NP 700 NA 680	MXR 600 NP 650 NA 630	MXR 600 NP 600 NA 580	MXR 500 NP 550 NA 530	NP 500 NA 490
40~45 lbs.	MXR 1200 NA 1000	NP 900 NA 900	MXR 900 NP 750 NA 730	MXR 800 NP 750 NA 730	MXR 700 NP 700 NA 680	MXR 600 NP 650 NA 630	MXR 600 NP 600 NA 580	MXR 500 NP 550 NA 530	MXR 500 NP 500 NA 490	NP 450 NA 450
46~51 lbs.	MXR 1000 NP 900 NA 900	MXR 900 NP 800 NA 830	MXR 800 NP 750 NA 730	MXR 700 NP 700 NA 680	MXR 600 NP 650 NA 630	MXR 600 NP 600 NA 580	MXR 600 NP 500 NA 530	MXR 500 NP 500 NA 490	NP 450 NA 450	NP 400 NA 410
52~57 lbs.	NP 800 NA 830	NP 750 NA 730	NP 700 NA 680	NP 650 NA 630	NP 600 NA 580	NP 550 NA 530	NP 500 NA 490	NP 450 NA 450	NP 400 NA 410	NA 380
58~63 lbs.	NP 750 NA 730	NP 700 NA 680	NP 650 NA 630	NP 600 NA 580	NP 550 NA 530	NP 500 NA 490	NP 450 NA 450	NP 400 NA 410	NA 380	
64~69 lbs.	NP 700 NA 680	NP 650 NA 630	NP 600 NA 580	NP 550 NA 530	NP 500 NA 490	NP 450 NA 450	NP 400 NA 410	NA 380		
70~75 lbs.	NP 650 NA 630	NP 600 NA 580	NP 550 NA 530	NP 500 NA 490	NP 450 NA 450	NP 400 NA 410	NA 380			

## EZ FLETCHER

### MULTI-FUNCTION SYSTEM!!

Better accuracy and convenience  
 Developed stability, certain control system  
 Perfect balance for every arrow  
 Holding system for the best set up  
 Easy to use, ergonomic design

**EZ FLETCHER** by BJD Technology has  
 Shaft Hold System, Pincers Control System  
 and Strenght Adjustment System.  
 Easy to use Ergonomic Design System.



Shaft Hold System



#### FEATURE

MATERIAL : Aluminum  
 SIZE : 124 x 124 x 220  
 COLOR : Black



[FTC]



## OUTDOOR TARGET FACE

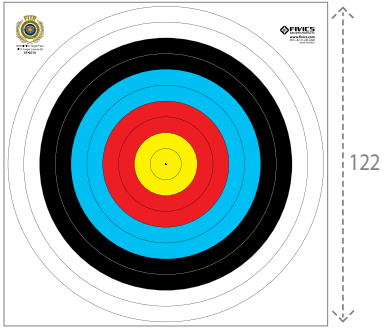

Name : OUTDOOR 122cm Target Face [PT 001]  
Range : 90m / 70m / 60m  
Mark dimension : 122cm X 122cm  
Total dimension : 125cm X 125cm (width/length)

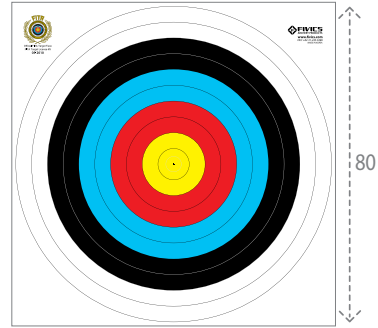

Name : OUTDOOR 80cm Target Face [PT 002]  
Range : 50m / 30m  
Mark dimension : 80cm X 80cm  
Total dimension : 83cm X 83cm (width/length)

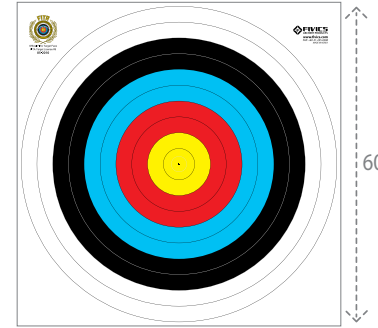

Name : OUTDOOR 60cm Target Face [PT 003]  
Range : 25m  
Mark dimension : 60cm X 60cm  
Total dimension : 63cm X 63cm (width/length)

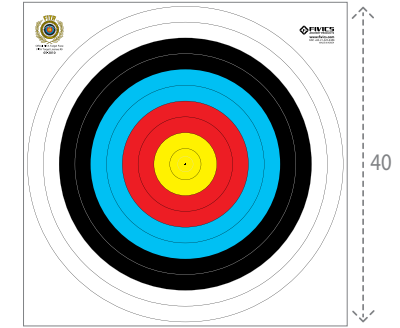

Name : OUTDOOR 40cm Target Face [PT 004]  
Range : 18m  
Mark dimension : 40cm X 40cm  
Total dimension : 43cm X 43cm (width/length)



Name : OUTDOOR 40cm-5ring Target Face [PT 005]  
Range : 30m / 20m  
Mark dimension : 40cm X 40cm  
Total dimension : 43cm X 43cm (width/length)



Name : OUTDOOR(3X40W) Triangular Target face(5Line) [PT 006]  
Range : 30m / 20m  
Mark dimension : (40cm-Center X 3Target)  
Total dimension : 85cm X 85cm (width/length)



Name : OUTDOOR(4X40w) Target face(5Line) [PT 007]  
Range : 30m / 20m  
Mark dimension : (40cm-Center X 4Target)  
Total dimension : 93cm X 85cm (width/length)



Name : OUTDOOR 48cm-6ring Target Face [PT 007A]  
Range : 50m  
Mark dimension : 48cm X 48cm  
Total dimension : 51cm X 51cm (width/length)

## OUTDOOR TARGET FACE



Name : OUTDOOR(3X48W) Triangular Target face(6Line) [PT 007A3]

Range : 50m

Mark dimension : (48cm-Center X 3Target)

Total dimension : 99cm X 98.5cm (width/length)

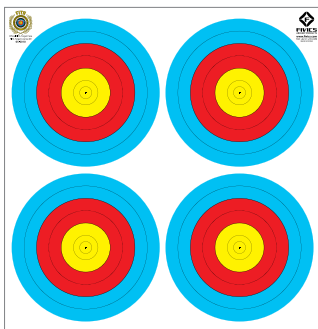

Name : OUTDOOR(4X48W) Triangular Target face(6Line) [PT 007A4]

Range : 50m

Mark dimension : (48cm-Center X 4Target)

Total dimension : 102cm X 105cm (width/length)

## INDOOR TARGET FACE

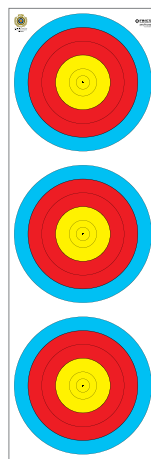

Name : INDOOR 20cm(3X20W) Target Face(18m) [PT 008]

Range : 18m

Mark dimension : 20cm X 3Target

Total dimension : 23cm X 67cm (width/length)

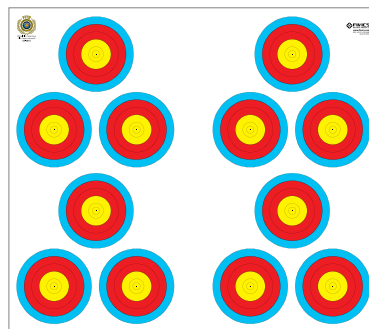

Name : INDOOR 12cm(3X20W)

Target Face(18m) [PT 010]

Range : 18m

Mark dimension : 20cm X 12Target

Total dimension :

103cm X 67cm (width/length)



Name : INTDOOR (4X40cm)

Single Target Face [PT 009]

Range : 18m

Mark dimension : 40cm X 4Target

Total dimension :

93cm X 85cm (width/length)

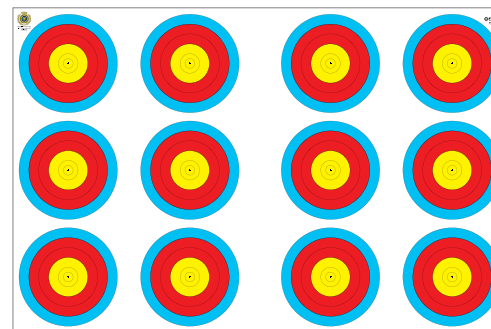

Name : INTDOOR 20cm Triangular Triple Target Face [PT 011]

Range : 18m

Mark dimension : 20cm X 3 X 12Target

Total dimension : 97cm X 85cm (width/length)

## STICKER TARGET FACE

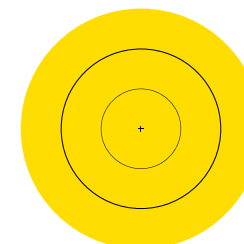

Name : Sticker Target Face [PT 018]

Range : 90m / 70m / 60m

Mark dimension : 15.8cm X 15.8cm

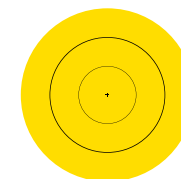

Name : Sticker Target Face [PT 019]

Range : 50m / 30m

Mark dimension : 24.3cm X 24.3cm



## TRAINING TARGET FACE



Name : TRAINING 80cm-CenterSpot Target Face(8Line) [PT 012]  
 Range : 50m/30m/20m  
 Mark dimension : 24cmX24cm  
 Total dimension : 32cmX32cm(width/length)



Name : TRAINING 122cm-CenterSpot Target Face(7Line) [PT 013]  
 Range : 90m/70m/60m  
 Mark dimension : 48.8cmX48.8cm  
 Total dimension : 61cmX61cm(width/length)

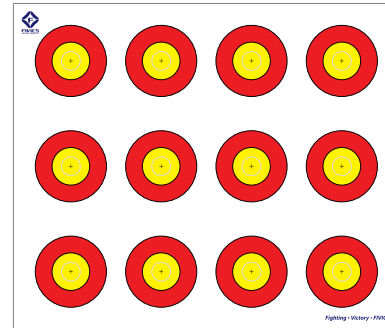

Name : TRAINING Target Face [PT 020]  
 Mark dimension : 52mmX52mm  
 Total dimension : 282mmX238mm(width/length)

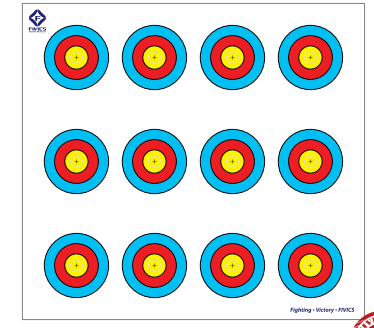

Name : TRAINING Target Face [PT 021]  
 Mark dimension : 48mmX48mm  
 Total dimension : 250mmX231mm(width/length)



## FIELD TARGET FACE

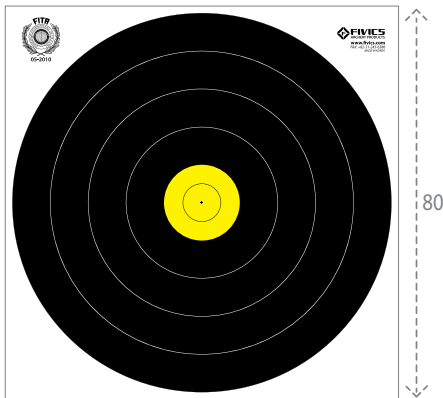

Name : FIELD 80cm Target Face [PT 014]  
 Mark dimension : 80cmX80cm Target  
 Total dimension : 83cmX83cm(width/length)

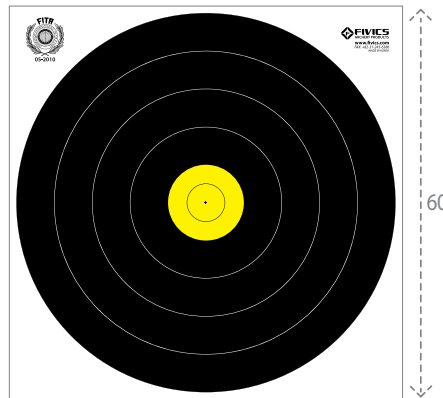

Name : FIELD 60cm Target Face [PT 015]  
 Mark dimension : 60cmX60cm Target  
 Total dimension : 63cmX63cm(width/length)

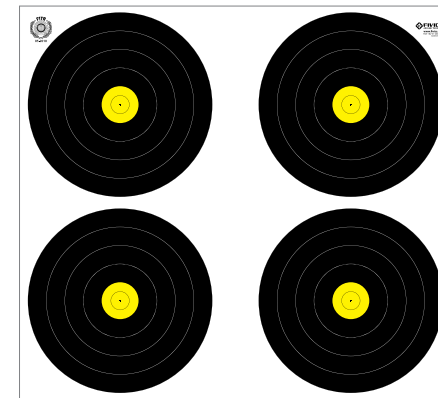

Name : FIELD 40cm(4X40W) Target Face [PT 016]  
 Mark dimension : 40cmX40cm  
 Total dimension : 93cmX85cm(width/length)

# FOAM TARGET FACE

Combination of durable form and Smart technology of FT system.  
 No impurities on FIVICS foam target,  
 No glues used.  
 Simple replacement of the incore.  
 Easy arrow removal.  
 Water proof.  
 The surface of the target foam is strong and hard enough.  
 Don't worry about any weather condition with FIVICS target face.  
 To fit your needs.

- **Name : A Foam Target**  
 Exterior A  
 Size : 125cmX125cmX18cm  
 Weight : 20.4kg
- Incore A  
 Size : 63cmX63cmX33cm  
 Weight : 13.6kg

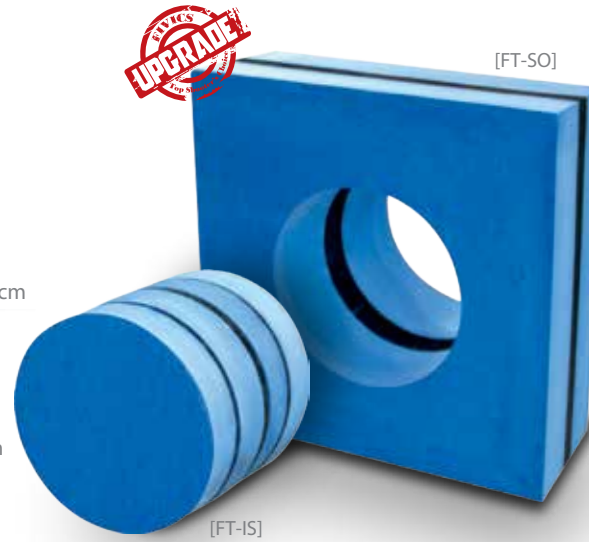

- **Name : B Foam Target**  
 Exterior B  
 Size : 95cmX95cmX24cm  
 Weight : 22.9kg
- Incore B  
 Size : 24cm X 24cm X 50cm  
 Weight : 1.4kg

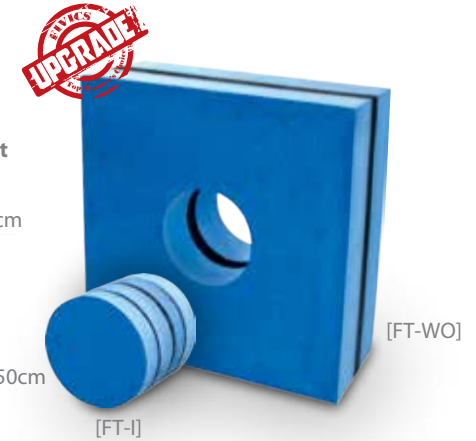

# ACADEMIC TARGET FACE



Name : OUTDOOR Target Face [PT 017]  
 Range : 70m  
 Mark dimension : 97.2cmX97.2cm  
 Total dimension : 103cmX103cm(width/length)

# PERFECT SCORE SHEET



Name : Perfect score sheet  
 Total dimension : A4(21 X 29.7)  
 Applicable under any weather condition  
 Ink not smudged

- **Name : C Foam Target**  
 Exterior C  
 Size : 104cmX104cmX9cm  
 Weight : 9.5kg



World Top shooter's with FIVICS!

## ADVANCED SPACE-AGE TECHNOLOGY





## Top Shooter's Choice!

We highly appreciate that they trust and use FIVICS products, we do our best to give them the most satisfaction through the best quality products.

